

# U Channel

## UHMW/PE

- Low friction, wear resistant cap clips on flat bar material
- Provides belt and chain support and edge protection
- Reduces noise
- Ultra smooth finish

Standard UHMW/PE U Channel are white and come in 250 and 500 foot coils. Easily available with Anti-Static, Lubricated, and Anti-Microbial additives.

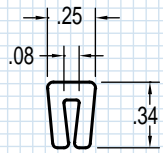

SPX 1931926  
CAT UB-0062  
For 1/16" Bar or  
16 Gauge Steel

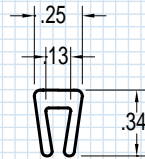

SPX 1012710  
CAT UB-0125  
For 1/8" Bar or  
11,12 Gauge Steel

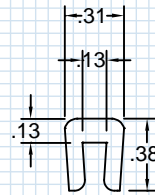

SPX 1861344  
CAT UC-0125S  
For 1/8" Bar or  
11,12 Gauge Steel

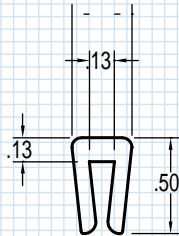

SPX 1002618  
CAT UC-0125  
For 1/8" Bar or 11,12 Gauge Steel

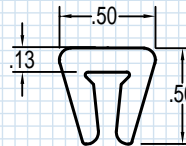

SPX 1002611  
CAT UC-0188  
For 3/16" Bar

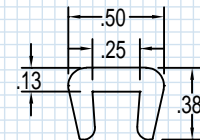

SPX 1012708  
CAT UC-0250S  
For 1/4" Bar

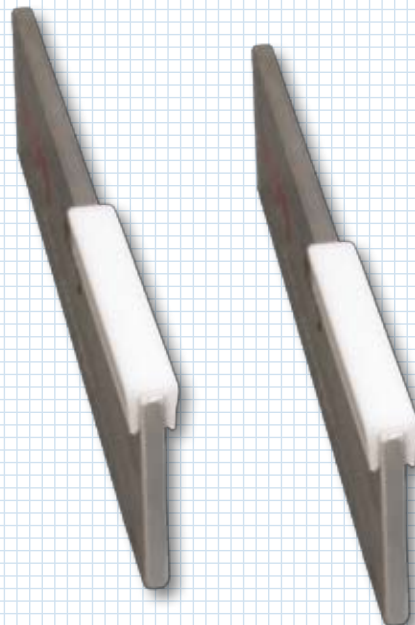

Custom colors and sizes available

734.722.0100

# U Channel

## UHMW/PE...continued

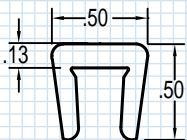

SPX 1002624  
CAT UC-0250  
For 1/4" Bar

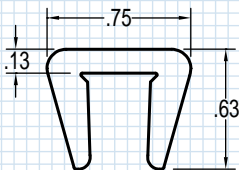

SPX 1002619  
CAT UC-0375  
For 3/8" Bar

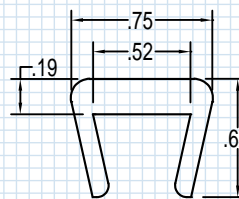

SPX 1032960  
CAT UE-0500  
For 1/2" Bar

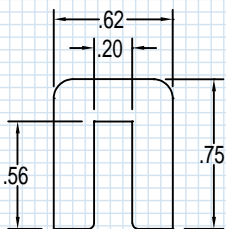

SPX 1022869  
CAT PE-2869  
For 3/16" Bar

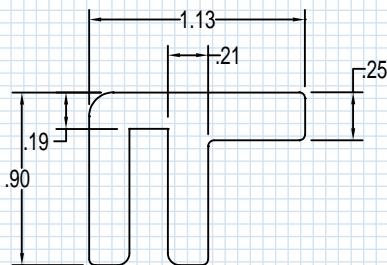

SPX 1022786  
CAT PE-2786  
For 3/16" Bar  
for Chain w/Hold Down Tab

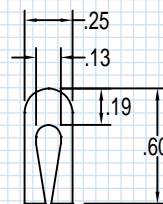

SPX 1032898  
CAT UE-2898  
For 1/16" Bar  
16 Gauge Hemmed Steel

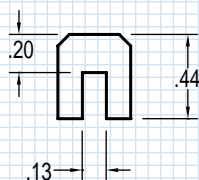

SPX 1992446  
CAT PF-0125  
For 1/8" Bar or  
11,12 Gauge Steel

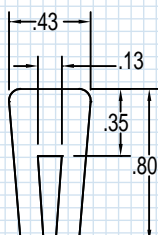

SPX 1962170  
CAT UH-0125  
For 1/8" Bar or  
11,12 Gauge Steel

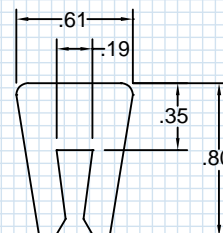

SPX 1720436  
CAT UH-0188  
For 3/16" Bar