



## Roller Selection



Solus offers a line of conveyor rollers and components which are engineered to provide totally maintenance free service. These rollers are quiet, need no lubrication, are extremely corrosion resistant, and can be used in wet applications. Contamination does not readily adhere to the surface of our rollers, which helps to keep the conveyor clean and trouble-

free. Our plastic rollers work well with conveyor belts, and can actually increase conveyor belt life through reduced belt abrasion. These rollers are available in a vast selection of sizes, materials and configurations as shown on the following pages. Please call 866-765-8744 to review your design requirements or fax your specifications to 866-447-6587.

## Roller Selection Flowchart

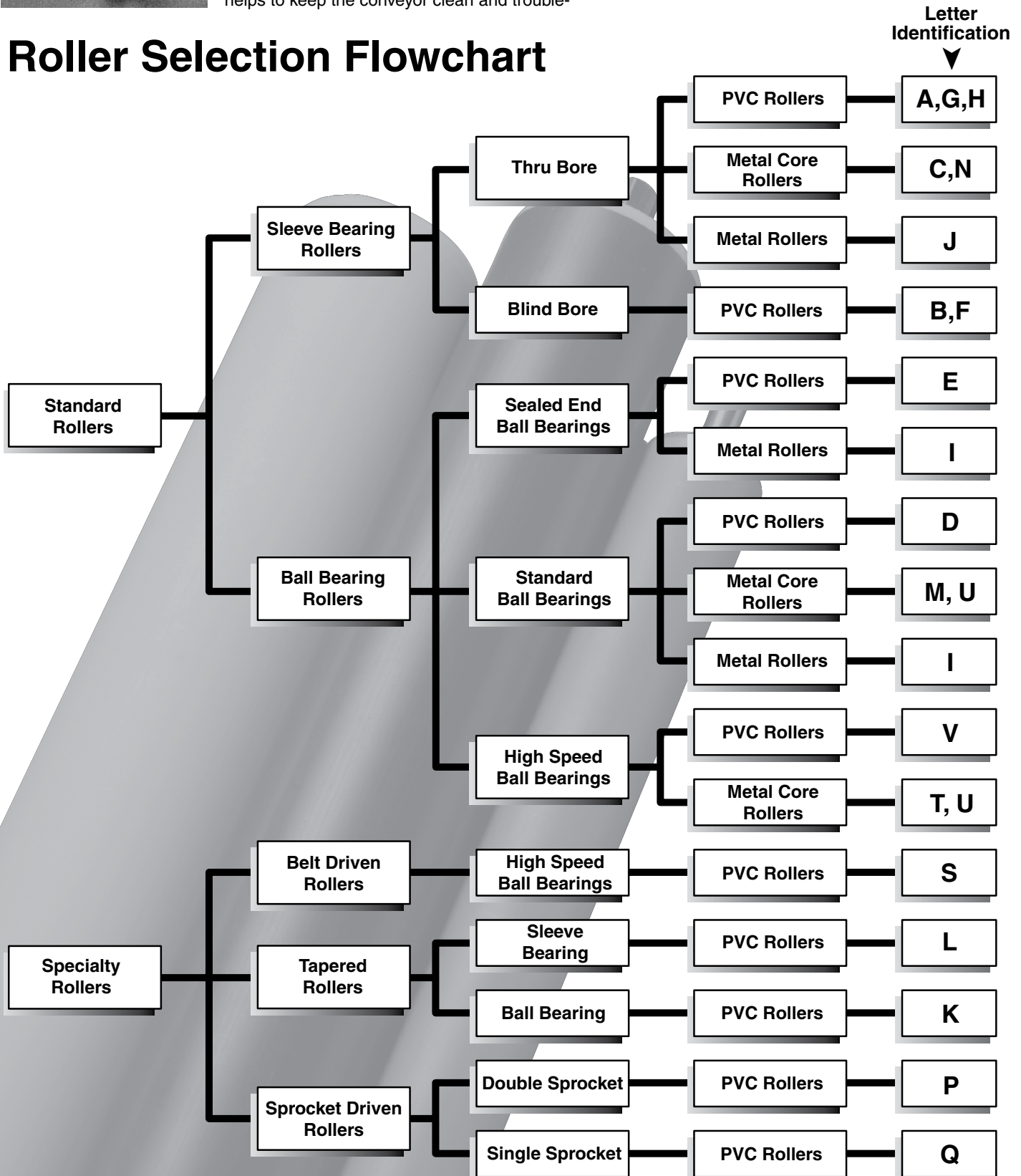

## Roller Components

Standard and custom roller options are shown in the chart below.			Roller Type																			
			A	B	C	D	E	F	G	H	I	J	K	L	M	N	P	Q	S	T	U	V
Shaft	Shape	7/16 hex	•		•				•	•	•	•	•	•	•	•	•	•	•	•		
		5/16 hex			•	•															•	•
		1/2 round	•	•	•	•		•	•	•		•		•		•	•	•				
		5/8 round		•																		
		1/4 round																				
		Other round				•	*	•														
	Material	Carbon steel	•		•				•	•	•	•	•	•	•	•	•	•	•	•		
		304 stainless	•		•	•	•	•	•	•	•	•	•	•	•	•	•	•	•	•	•	•
		316 stainless	•		•	•			•	•	•	•	•	•	•	•	•	•	•	•	•	•
	Through (included)		•		•	•			•	•	•	•	•	•	•	•	•	•	•	•	•	•
	Stub (sold separately)			•		•		•													•	•
	Hex adapter available		•		•				•	•		•		•		•	•	•				
Roller	Diameter	.81								•	♦											
		1.06				•				•												
		1.19				•				•												
		1.31				•																
		1.66				•				•												
		1.90	•	•	•		•	•	•	•	•				•	•	•	•	•	♦		
		2.25	•	•		•				•							•	•			♦	•
		2.38	•	•	•		•	•	•	•							•	•	•			
		2.50	•	•						•							•	•				
		2.88	•	•						•							•	•				
	Material	PVC	•	•			•	•	•	•			•	•	•	•	•	•	•			
		Aluminum			•	•					•									•		•
		UHMW			•															•		
		Stainless steel									•	•										
		Carbon steel									•	•			•	•						
		Urethane																			•	
	Tapered												•	•							•	
	With sprocket																•	•			•	
	Grooved																		•			
Bearing	Type	Sleeve			•			•		•		•		•								
		Plug with sleeve	•	•					•								•	•	•			
		Ball					•						•		•				•	•		
		Ball, sealed				•					•											•
	Material	Plastic with metal balls					•				•		•		•				•	•	•	
		Nyla-Ride	•	•		•											•	•	•		•	•
		Nolu-S UHMW	•	•	•					•		•		•			•	•	•			
		Arguto-K wood										•										
		Acetal						•	•													
		UHMW								•		•										

\* 5/16 threaded stub shaft included

♦ Roller diameter depends on bearing selection

❖ 2.0 inches

Conveyor Rollers



## Rollers

Items have 3 day lead time for assembly

### Type A

#### PVC Roller with High Performance Sleeve Bearing

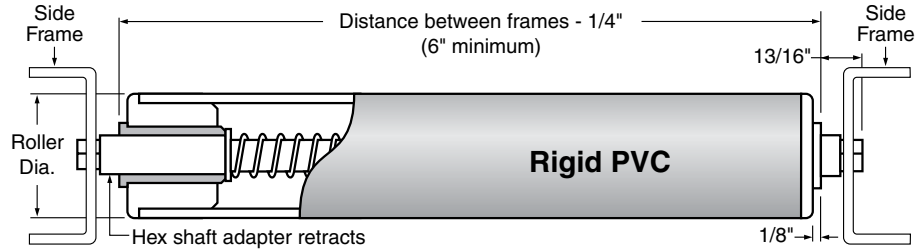
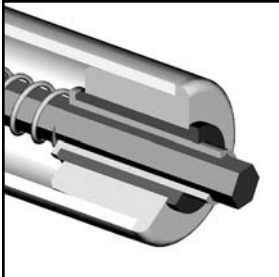

Our most popular all plastic roller, designed for belt driven conveyors and inclined gravity systems. Standard shafts extend 13/16" at each end of a roller. Custom extended shaft lengths are available. This roller can be purchased without a shaft if you prefer (leave shaft information out of part number).

Roller material: beige, rigid PVC.  
End plug material: beige ABS.

See page 338 for Type A Roller standard part numbers.

Bearing Type:	Sleeve
Bore Type:	Through
Roller Material:	PVC

Shaft Material	Hex Adapter Material	Roller Diameter	Bearing Material	Distance Between Frames
Part No.	Part No.	Part No.	Part No.	
Description	Description	Description	Description	
CS Carbon steel	C Carbon steel	R220 1.90"	S Nolu-S	
304SS 304 stainless	316SS 316 stainless	R250 2.25"		
316SS 316 stainless		R270 2.38"		
		R280 2.50"		
		R320 2.88"		

7/16 hex shaft	A-7/16hex-				
1/2" round shaft	A-1/2				

### Type B

#### PVC Roller with High Performance Blind Bore Sleeve Bearing

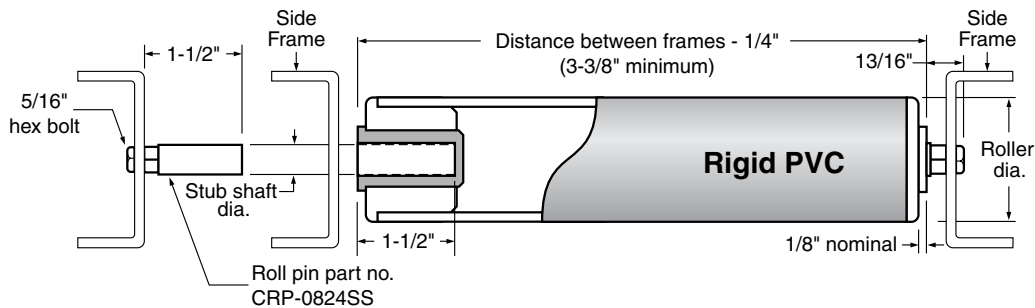
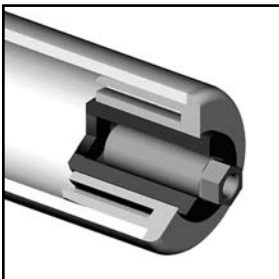

Designed for belt driven conveyors and inclined gravity systems where added cleanliness is required. The blind bore sleeve bearing can accommodate a 1/2" or 5/8" stainless steel stub shaft or extended pin chain attachments. The standard roller is bored to suit part number CRP-0824SS which is 1/2" dia., 316 stainless steel, and can be bolted to your side frame.

Roller material: beige, rigid PVC.  
End plug material: beige ABS.

See page 339 for Type B Roller standard part numbers.

Bearing Type:	Sleeve
Bore Type:	Blind
Roller Material:	PVC

Stub Shaft Diameter	Roller Diameter	Bearing Material	Distance Between Frames
Part No.	Part No.	Part No.	
Description	Description	Description	
1/2"	R220 1.90"	S Nolu-S	
5/8"	R250 2.25"		
	R270 2.38"		
	R280 2.50"		
	R320 2.88"		

B-				
----	--	--	--	--

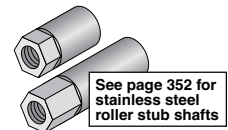

See page 352 for stainless steel roller stub shafts

Solus



Items have 3 day lead time for assembly

## Type C

### UHMW Roller with High Performance Sleeve Bearing

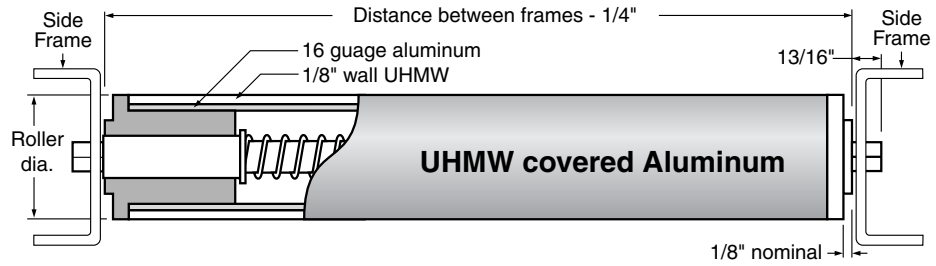
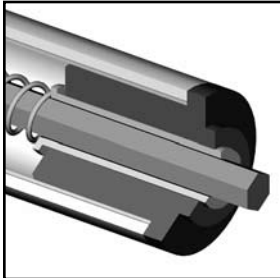

Our UHMW roller, reinforced with an aluminum tube, offers maximum abrasion resistance. Designed primarily for belt driven conveyors, the plastic sleeve bearings is an excellent choice for applications exposed to abrasive or corrosive products, candy production or printing where a non-stick surface is required. Standard shafts extend 13/16" at each end of a roller. Custom extended shaft lengths are available.

Roller material: aluminum, UHMW.

Bearing Type:	Sleeve
Bore Type:	Through
Roller Material:	UHMW covered aluminum

Shaft Diameter	Shaft Material	Hex Adapter Material	Roller Diameter	Bearing Material	Distance Between Frames
Part No.	Description	Part No.	Description	Part No.	Description
7/16 hex	7/16" hex	CS	Carbon steel	R220	1.90"
5/16 hex	5/16" hex	304SS	304 stainless	R270	2.38"
1/2	1/2" round	316SS	316 stainless	S	Nolu-S
			Use with hex shaft.		
C-					
C-					

w/ round shaft →

## Type D

### PVC Roller with Nolu Plastic Ball Bearing

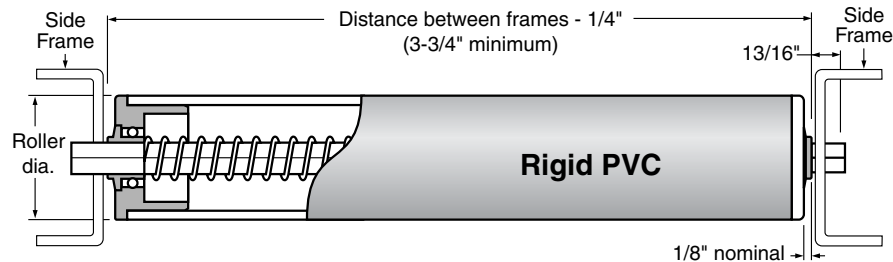
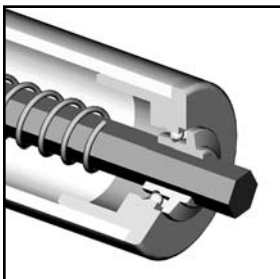

A cost effective lighter duty roller designed primarily for gravity conveyor applications. Standard shafts extend 13/16" at each end of a roller. Custom extended shaft lengths are available.

Roller material: beige, rigid PVC.

Bearing Type:	Ball
Bore Type:	Through
Roller Material:	PVC

See page 339 for Type D Roller standard part numbers.

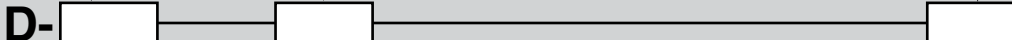
Shaft Material		Roller Diameter, Shaft Diameter and Bearing Material				Distance Between Frames
Part No.	Description	Part No.	Roller Dia.	Shaft Dia.	Bearing Material	
CS	Carbon steel	NBB110	.81"	1/4" round	Acetal w/ 420 stainless balls	
304SS	304 stainless	NBB130	1.06"	5/16" hex	Acetal w/ 420 stainless balls	
316SS	316 stainless	NBB145	1.19"	5/16" round	Acetal w/ 420 stainless balls	
		NBB150	1.31"	5/16" hex	Acetal w/ 420 stainless balls	
		NBB220	1.90"	7/16" hex	Acetal w/ 420 stainless balls	
		SPB220	1.90"	7/16" hex	Polypropylene w/ 316 stainless balls	
D-						

Conveyor Rollers



## Rollers

Items have 3 day lead time for assembly

### Type E

#### PVC Roller with Sealed End Ball Bearing

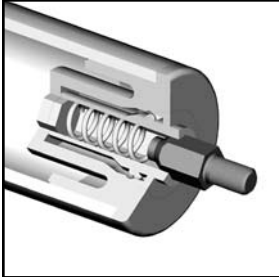

Bearing Type:	Ball
Bore Type:	Blind
Roller Material:	PVC

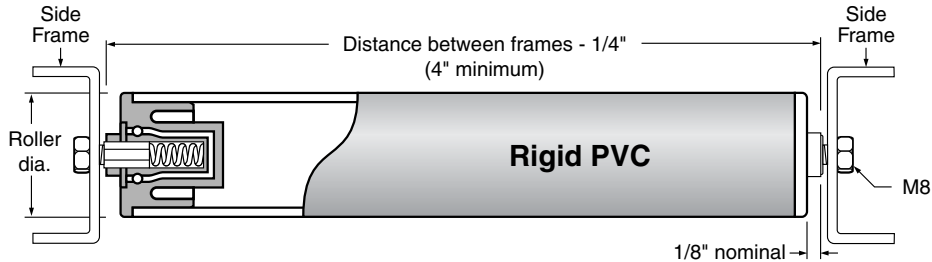

Our low friction roller with sealed end bearings prevents fluids and other contaminants from entering the tube. Useful in the processing industry due to the corrosion resistant materials that are USDA accepted for incidental contact with food products. Spring loaded, stainless steel stub shafts ease the assembly into a frame capable of accepting the M8 threaded attachments,

Roller material: beige, rigid PVC.

#### Estimated Bearing Life For Plastic Ball Bearings

Radial load lbs. per roller: ☐ 5 ☐ 10 ☐ 15

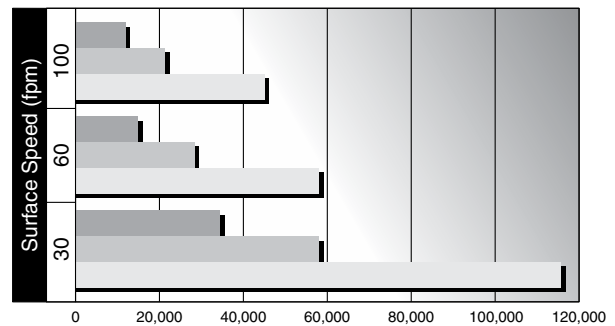

Estimated bearing life will be reduced by impact loads and by exposure of contaminants. If the distance between frames is greater than 12", load capacity will be limited by the rigidity of the PVC tubing.

Roller Diameter	Part No.	Description	Distance Between Frames
SBR220	1.90"		
SBR270	2.37"		

### Type F

#### PVC Roller with Blind-Bore Sleeve Bearing

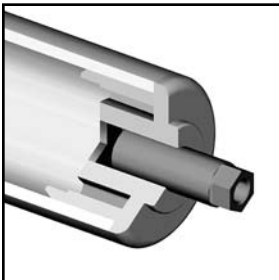

Bearing Type:	Sleeve
Bore Type:	Blind
Roller Material:	PVC

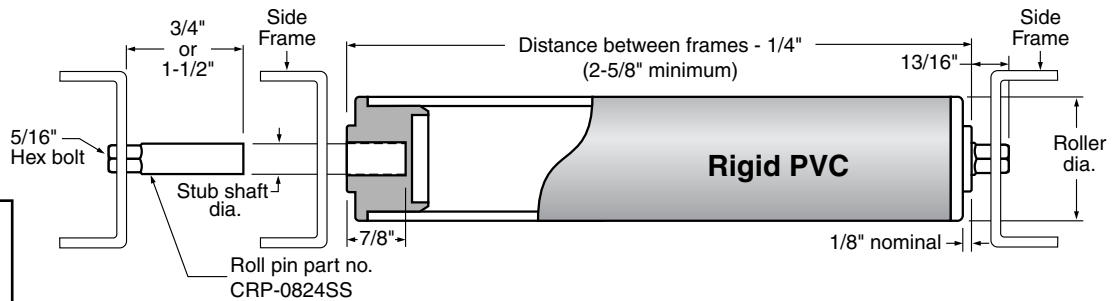

Type F roller is designed to provide added cleanliness and reduce potential areas of contamination. The one piece, blind bore sleeve bearing can accommodate a stainless steel roller stub shaft or extended pin chain attachment up to  $\varnothing 5/8"$ . Unless specified otherwise, rollers come with  $\varnothing 1/2"$  bores that can be used with our  $\varnothing 1/2"$ , 316 stainless steel roller stub shafts (see page 352) which are bolted directly to the side frame.

Roller material: beige, rigid PVC.  
End plugs/bearing: beige acetal.

Stub Shaft Diameter	Roller Diameter	Part No.	Description	Distance Between Frames
1/2" (other)	NR220	1.90"		
	NR270	2.38"		

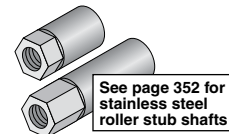



Items have 3 day lead time for assembly

## Type G

### PVC Roller with Sleeve Bearings

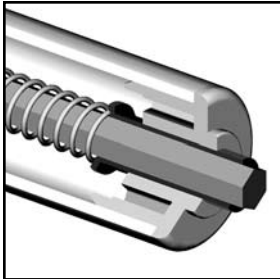

Bearing Type:	Sleeve
Bore Type:	Through
Roller Material:	PVC

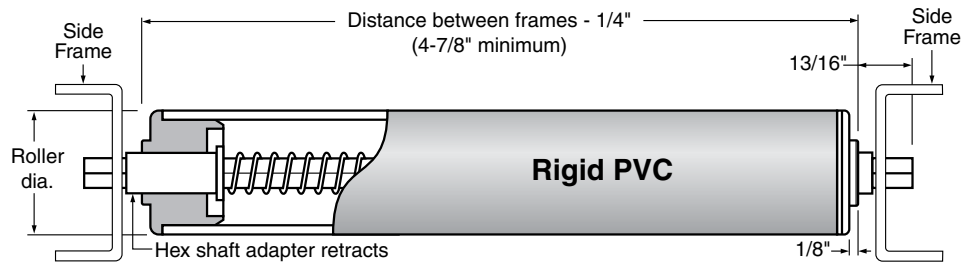

Our economical, light duty roller with a selection of steel shaft assemblies. Designed to support the return side of belt conveyors and inclined gravity systems. Standard shafts extend 13/16" at each end of a roller. Custom extended shaft lengths are available. This roller can be purchased without a shaft if you prefer (leave shaft information out of part number).

Roller material: beige, rigid PVC.  
End plug material: beige acetal.  
Bearing material: beige acetal.

	Shaft Material		Hex Adapter Material		Roller Diameter		Distance Between Frames
	Part No.	Description	Part No.	Description	Part No.	Description	
7/16 hex shaft ➤	<b>CS</b>	Carbon steel	<b>C</b>	Carbon steel	<b>NR220</b>	1.90"	
w/ round shaft ➤	<b>304SS</b>	304 stainless	<b>316SS</b>	316 stainless	<b>NR270</b>	2.38"	
	<b>316SS</b>	316 stainless	<b>S</b>	Nolu-S			
				Use with hex shaft.			
	<b>G-7/16hex-</b>						
	<b>G-1/2</b>						

## Type H

### PVC Roller with One Piece End Plugs of Sleeve Bearing Material

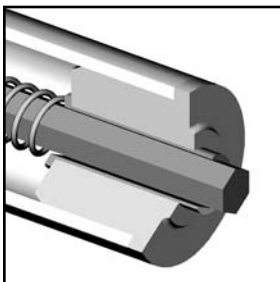

Bearing Type:	Sleeve
Bore Type:	Through
Roller Material:	PVC

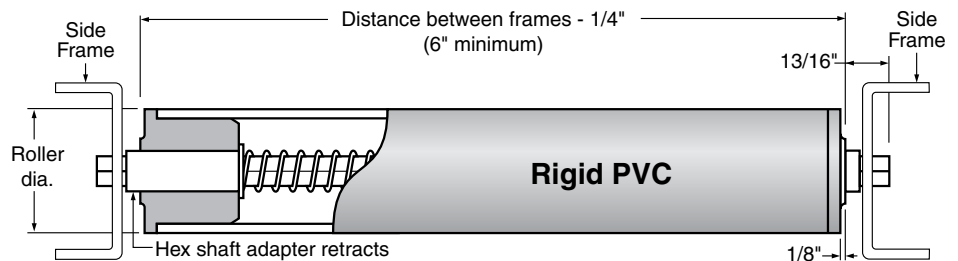

Designed for belt driven conveyors offering all the advantages of a plastic roller and eliminates all the problems associated with the use of ball bearings. Standard shafts extend 13/16" at each end of a roller. This roller can be purchased without a shaft if you prefer (leave shaft information out of part number).

Roller material: beige, rigid PVC.  
Bearing material: UHMW, Nolu-S.

	Shaft Material		Hex Adapter Material		Roller Diameter and Material			Distance Between Frames
	Part No.	Description	Part No.	Description	UHMW#	Nolu-S #	Description	
7/16 hex shaft	<b>CS</b>	Carbon steel	<b>C</b>	Carbon steel	<b>HT130</b>	or <b>ST130</b>	1.06"	
w/ round shaft	<b>304SS</b>	304 stainless	<b>316SS</b>	316 stainless	<b>HT145</b>	or <b>ST145</b>	1.19"	
	<b>316SS</b>	316 stainless			<b>HR190</b>	or <b>ST190</b>	1.66"	
					<b>HR220</b>	or <b>SR220</b>	1.90"	
					<b>HR250</b>	or <b>SR250</b>	2.25"	
					<b>HR270</b>	or <b>SR270</b>	2.38"	
					<b>HR280</b>	or <b>SR280</b>	2.5"	
					<b>HR320</b>	or <b>SR320</b>	2.88"	
				Use with hex shaft.				
	<b>H-7/16hex-</b>							
	<b>H-1/2</b>							

Conveyor Rollers



## Rollers

Items have 3 day lead time for assembly

### Type I

#### Steel Roller with Plastic Ball Bearing

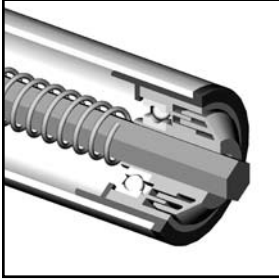

Bearing Type:	Ball
Bore Type:	Through
Roller Material:	Steel

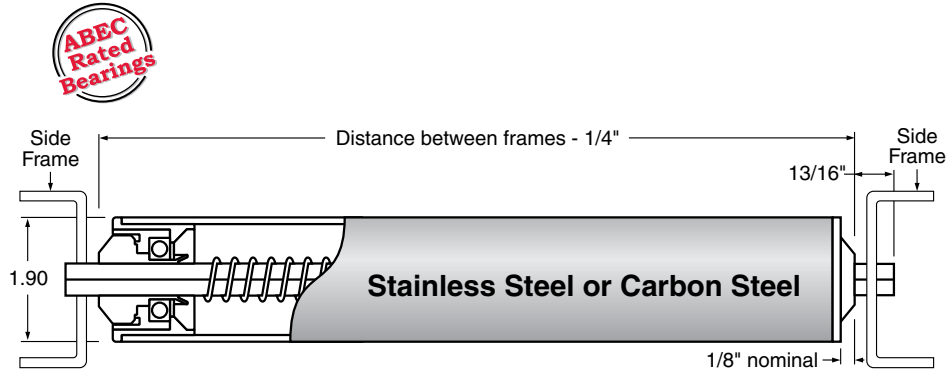

Designed primarily for belt driven conveyors and inclined gravity systems where a heavy duty roller is required. Standard shafts are 7/16" hex and extend 13/16" at each end of a roller. Custom extended shaft lengths are available.

Roller material: stainless or carbon steel.

**See page 339 for Type I Roller standard part numbers.**

Shaft Material	Bearing	Shaft Diameter	Tubing Material	Distance
Part No.	Part No.	Description	Part No.	Between
Description	Description		Description	Frames
CS Carbon steel	222LSB-224-01 Plastic housing with carbon steel caged bearing insert	7/16	2 Carbon steel	
304SS 304 stainless	222LSB-224-02 Plastic housing with carbon steel double shielded bearing insert		3 304 stainless	
316SS 316 stainless	222LSB-224-03 Plastic housing with carbon steel double rubber sealed bearing insert			

### Type J

#### Steel / Aluminum Roller with Non-Metallic Sleeve Bearings

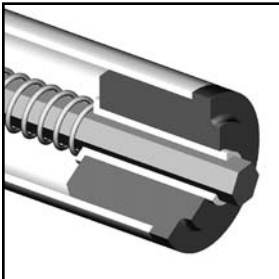

Bearing Type:	Sleeve
Bore Type:	Through
Roller Material:	Steel

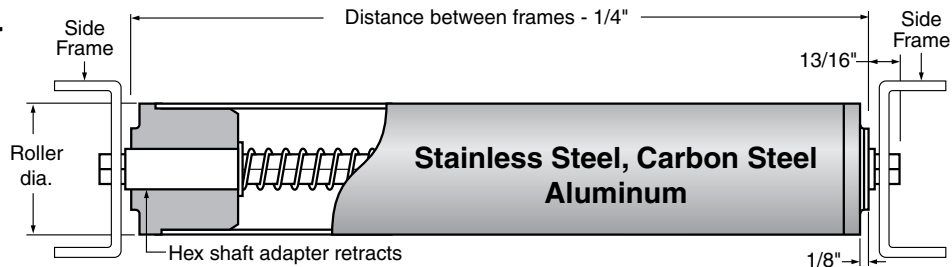

Roller can be produced from most standard tube sizes and using a conveyor roll end bearing from the table on page 353. Designed primarily for belt driven conveyors and inclined gravity systems. It provides the same rigidity as other metal tube rollers and yet eliminates all the problems associated with the use of ball bearings. Standard shafts extend 13/16" at each end of a roller. Custom extended shaft lengths are available. This roller can be purchased without a shaft if you prefer (leave shaft information out of part number).

Roller material: stock steels or aluminum.

Shaft Material	Hex Adapter Material	Roller Dia., Gage,	Tubing Material	Distance
Part No.	Part No.	Bearing Material	Part No.	Between
Description	Description	& Bore size	Description	Frames
CS Carbon steel	C Carbon steel	(see pg. 353)	2 Carbon steel	
304SS 304 stainless	316SS 316 stainless	(e.g. HR-234J)	3 304 stainless	
316SS 316 stainless			5 Aluminum	

7/16 hex shaft ➔ **J-7/16hex-**

w/ round shaft ➔ **J-1/2**

**Solus**





Items have 3 day lead time for assembly

## Type K

### Tapered PVC Roller with Plastic Ball Bearing

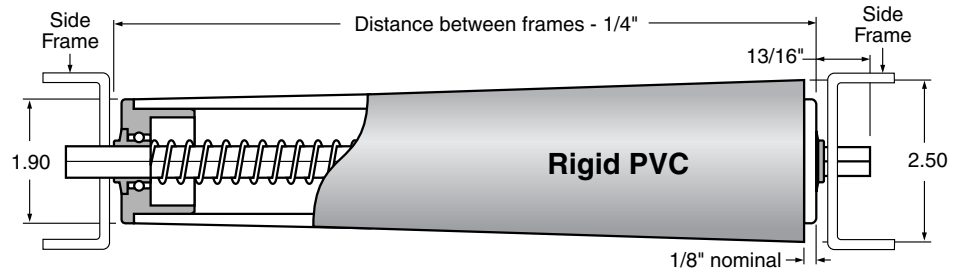
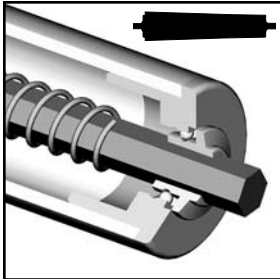

Designed primarily for gravity conveyors where a clean, corrosion free environment is required. The bearings are unaffected by most normal washdown procedures. Standard shafts extend 13/16" at each end of a roller. Custom extended shaft lengths are available.

Roller material: gray, rigid PVC hollow bar.

Bearing Type:	Ball
Bore Type:	Through
Roller Material:	PVC

Shaft Material	Part No.	Description	Roller Diameter, Shaft Diameter and Bearing Material	Part No.	Roller Dia.	Shaft Dia.	Bearing Material	Distance Between Frames
CS		Carbon steel	NBB220		1.90"	7/16" hex	Acetal w/ 420 stainless balls	
304SS		304 stainless	SPB220		1.90"	7/16" hex	Polypropylene w/ 316 stainless balls	
316SS		316 stainless						

## Type L

### Tapered PVC Roller with High Performance Sleeve Bearings

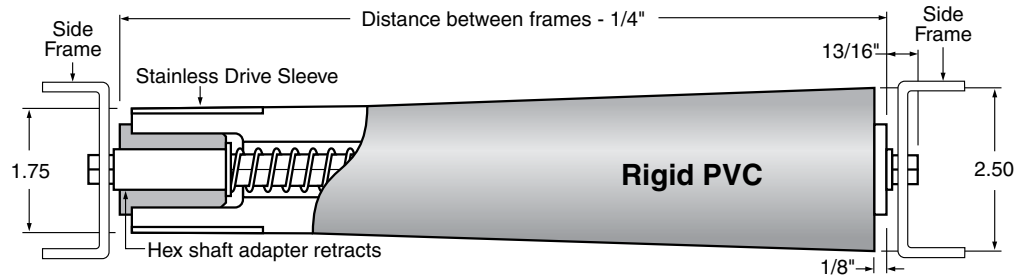
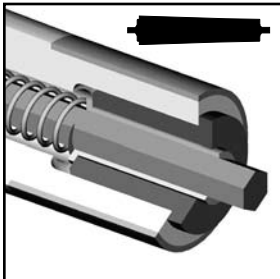

Designed for belt driven systems or can be fitted with UHMW sprockets. Standard shafts extend 13/16" at each end of a roller. Custom extended shaft lengths are available.

Roller material: gray, rigid PVC hollow bar.

Bearing Type:	Sleeve
Bore Type:	Through
Roller Material:	PVC

Shaft Material	Part No.	Description	Hex Adapter Material	Part No.	Description	Bearing Material	Part No.	Description	Distance Between Frames
CS		Carbon steel	C		Carbon steel	S		Nolu-S	
304SS		304 stainless	316SS		316 stainless				
316SS		316 stainless							

7/16 hex shaft ➤ **L-7/16hex-**

w/ round shaft ➤ **L-1/2**

Conveyor Rollers





## Rollers

Items have 3 day lead time for assembly

### Type M

#### Steel Reinforced PVC Roller with Plastic Ball Bearing

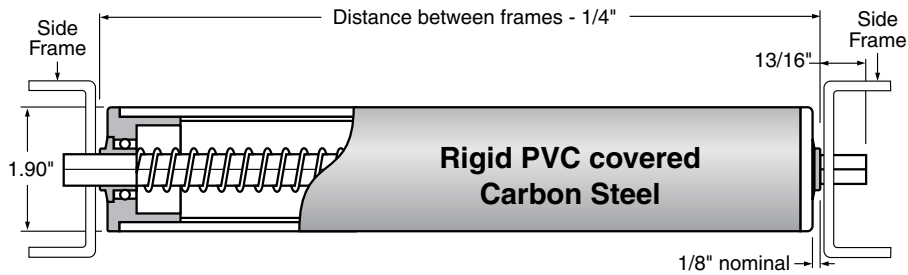
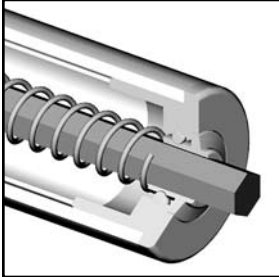

Designed primarily for gravity conveyors where a clean, corrosion free environment is required. The reinforcing tube will increase the load carrying capacity to the limit of the bearings. Standard shafts extend 13/16" at each end of a roller. Custom extended shaft lengths are available.

Roller material: beige, rigid PVC over carbon steel.

Bearing Type:	Ball
Bore Type:	Through
Roller Material:	PVC and steel

Shaft Material		Roller Diameter, Shaft Diameter and Bearing Material				Distance Between Frames
Part No.	Description	Part No.	Roller Dia.	Shaft Dia.	Bearing Material	
CS	Carbon steel	NBB220	1.90"	7/16" hex	Acetal w/ 420 stainless balls	↓
304SS	304 stainless	SPB220	1.90"	7/16" hex	Polypropylene w/ 316 stainless balls	
316SS	316 stainless					

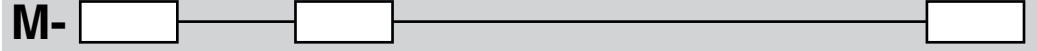

### Type N

#### Steel Reinforced PVC Roller with High Performance Sleeve Bearings

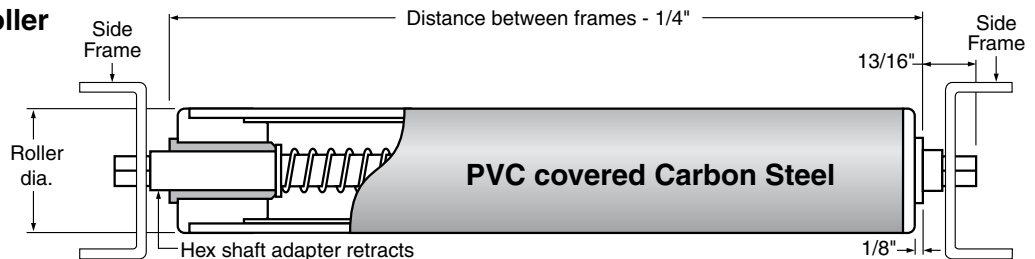
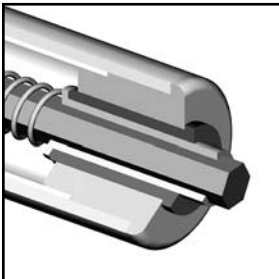

Designed primarily for belt driven conveyors and inclined gravity systems. Offers all the advantages of a plastic roller and eliminates the problem associated with the use of ball bearings. Standard shafts extend 13/16" at each end of a roller. Custom extended shaft lengths are available.

Roller material: beige, rigid PVC over carbon steel.  
End Plug material: beige, ABS.

Bearing Type:	Sleeve
Bore Type:	Through
Roller Material:	PVC and steel

Shaft Material		Hex Adapter Material		Roller Diameter		Bearing Material		Distance Between Frames
Part No.	Description	Part No.	Description	Part No.	Description	Part No.	Description	
CS	Carbon steel	C	Carbon steel	R220R	1.90"	S	Nolu-S	↓
304SS	304 stainless	316SS	316 stainless	R270R	2.38"			
316SS	316 stainless							

Use with hex shaft.

7/16 hex shaft ➤	N-7/16hex-						
w/ round shaft ➤	N-1/2						



Items have 3 day lead time for assembly

## Type P

### Double Sprocket PVC Roller with High Performance Sleeve Bearings

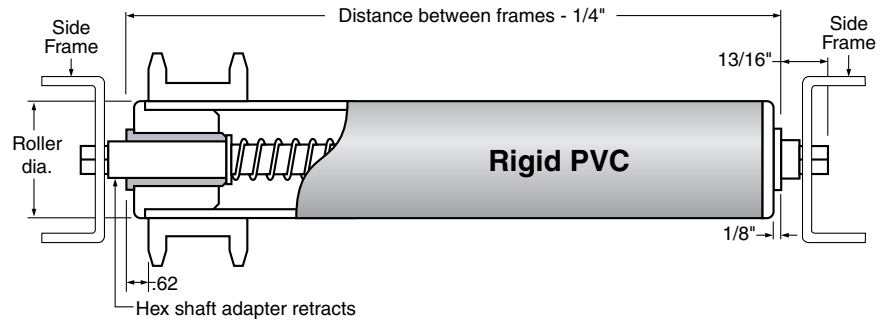
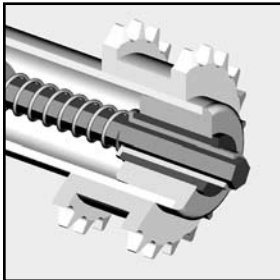

Our Type A roller with a UHMW double sprocket is available for various roller chains. In a driven system, the need for lubrication is eliminated. Better service life and chain wear is reduced. Noise levels are significantly reduced and the roller gains easy acceptance by the USDA and FDA. Standard shafts extend 13/16" at each end of a roller. Custom extended shaft lengths are available.

Roller material: beige, rigid PVC.  
End Plug material: beige, ABS.

Bearing Type:	Sleeve
Bore Type:	Through
Roller Material:	PVC

Shaft Material	Hex Adapter Material	Roller Diameter	Bearing Material	Roller Chain	Number	Distance
Part No.	Part No.	Part No.	Part No.	Number	of	Between
Description	Description	Desc.	Desc.		Teeth	Frames
<b>CS</b> Carbon steel	<b>C</b> Carbon steel	<b>R220</b> 1.90"	<b>S</b> Nolu-S			
<b>304SS</b> 304 stainless	<b>316SS</b> 316 stainless	<b>R250</b> 2.25"				
<b>316SS</b> 316 stainless		<b>R270</b> 2.38"				
		<b>R280</b> 2.50"				

7/16 hex shaft

P-7/16hex-

w/ round shaft

P-1/2

## Type Q

### Single Sprocket PVC Roller with High Performance Sleeve Bearings

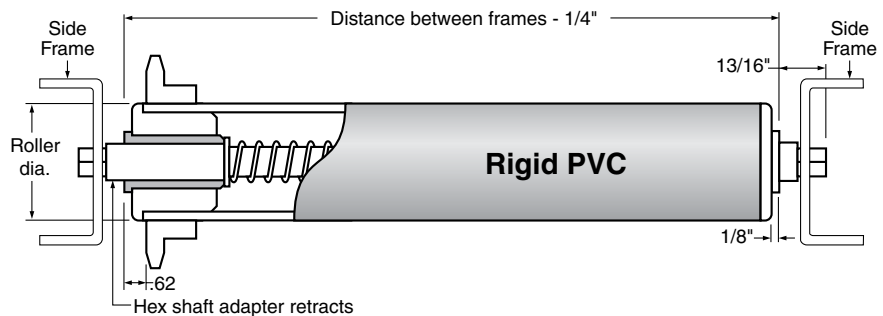
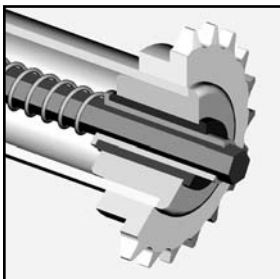

Our Type A roller with a UHMW single sprocket is available for various roller chains. In a driven system, the need for lubrication is eliminated. Better service life and chain wear is reduced. Noise levels are significantly reduced and the roller gains easy acceptance by the USDA and FDA. Standard shafts extend 13/16" at each end of a roller. Custom extended shaft lengths are available.

Roller material: beige, rigid PVC.  
End Plug material: beige, ABS.

Bearing Type:	Sleeve
Bore Type:	Through
Roller Material:	PVC

Shaft Material	Hex Adapter Material	Roller Diameter	Bearing Material	Roller Chain	Number	Distance
Part No.	Part No.	Part No.	Part No.	Number	of	Between
Description	Description	Desc.	Desc.		Teeth	Frames
<b>CS</b> Carbon steel	<b>C</b> Carbon steel	<b>R220</b> 1.90"	<b>S</b> Nolu-S			
<b>304SS</b> 304 stainless	<b>316SS</b> 316 stainless	<b>R250</b> 2.25"				
<b>316SS</b> 316 stainless		<b>R270</b> 2.38"				
		<b>R280</b> 2.50"				

7/16 hex shaft

Q-7/16hex-

w/ round shaft

Q-1/2

Conveyor Rollers



## Rollers

Items have 3 day lead time for assembly

### Type S



#### PVC Line Shaft Roller with Precision Ball Bearing

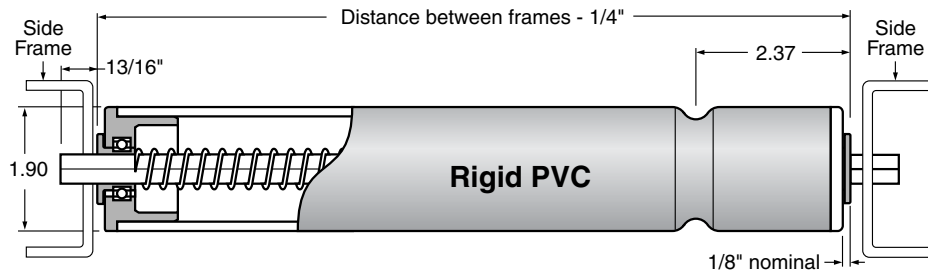
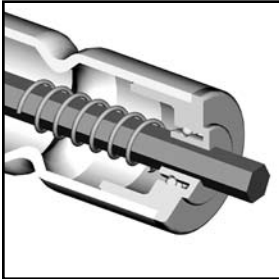

Plastic line shaft conveyor roller designed with a spring loaded 7/16" hex shaft. Noise levels are significantly reduced and surface build up is minimized. Standard shafts extend 13/16" at each end of a roller. Custom extended shaft lengths are available.

Roller material: beige, rigid PVC.

"O" ring groove material: machined into PVC.

Bearing is HPR-220 series precision ball bearing mounted in reinforced polypropylene.

Bearing Type:	Ball
Bore Type:	Through
Roller Material:	PVC

Shaft Material		Belt Diameter		
Part No.	Description	Part No.	Description	Distance Between Frames
CS	Carbon steel	3/16	3/16"	
304SS	304 stainless	1/4	1/4"	
316SS	316 stainless			

S-7/16hex-

### Type T



#### Aluminum reinforced UHMW Roller with Precision Ball Bearing

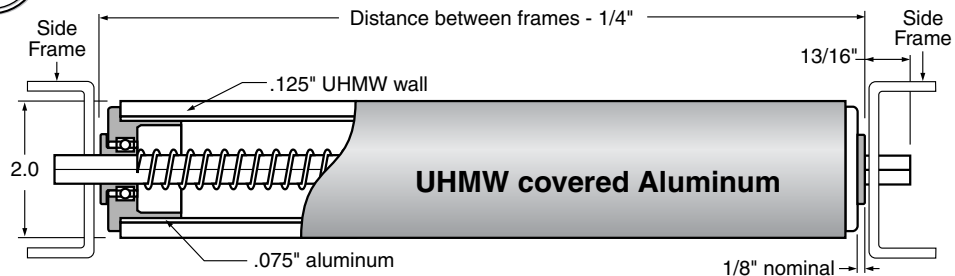
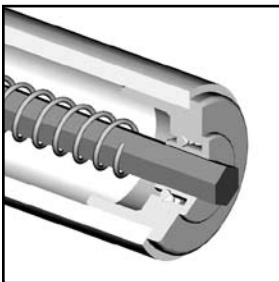

Maximum abrasion resistant roller, reinforced with an aluminum tube. Fitted with a high performance bearing assembly that provides the lowest coefficient of friction, excellent load carrying capacity and high speed capability in one roller. Noise levels are significantly reduced and surface build up is minimized. The UHMW tube offers a great non-stick roller surface for applications such as candy production or printing. Standard shafts extend 13/16" at each end of a roller. Custom extended shaft lengths are available.

Roller material: UHMW, aluminum.

Bearing is HPR-220 series precision ball bearing mounted in reinforced polypropylene.

Shaft Material		Distance Between Frames
Part No.	Description	
CS	Carbon Steel	
304SS	304 stainless	
316SS	316 stainless	

T-7/16hex-

**Solus**



Items have 3 day lead time for assembly

## Type U

### Urethane Covered Steel Roller with Plastic Ball Bearing

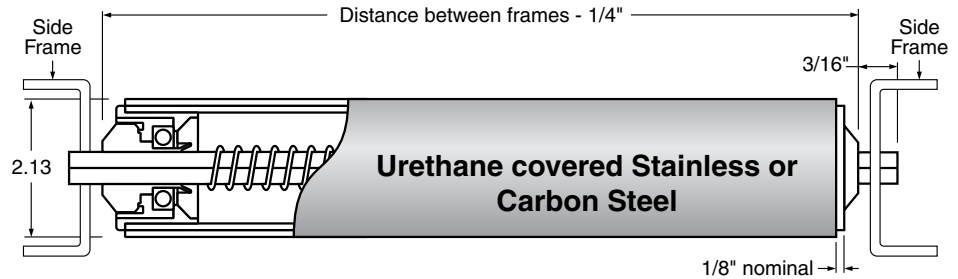
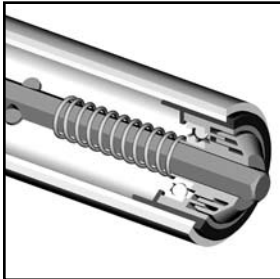

Bearing Type:	Ball
Bore Type:	Through
Roller Material:	Stainless or Carbon Steel

Designed primarily for belt driven conveyors and inclined gravity systems where a heavy duty roller is required. Urethane covering helps protect heavy products that require a flawless cosmetic appearance. Standard shafts are 7/16" hex and extend 13/16" at each end of a roller. Custom extended shaft lengths are available.

Roller material: stainless or carbon steel.

Shaft Material	Bearing		Shaft Diameter	Tubing Material	Distance
Part No.	Part No.	Description	Description	Part No.	Between
CS	222LSB-224-01	Plastic housing with carbon steel insert	7/16	2	Frames
304SS	222LSB-224-02	Plastic housing with carbon steel double shielded bearing insert		3	
316SS	222LSB-224-03	Plastic housing with carbon steel double rubber sealed bearing insert			

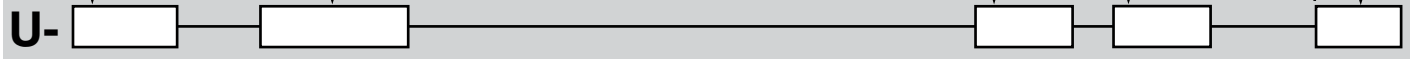

## Type V

### PVC Free-Turning Roller with Precision Ball Bearing

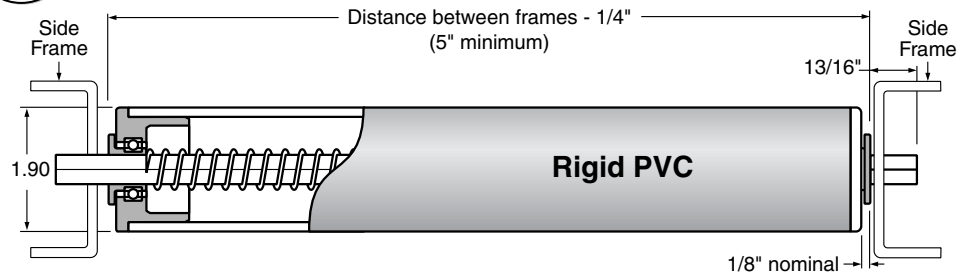
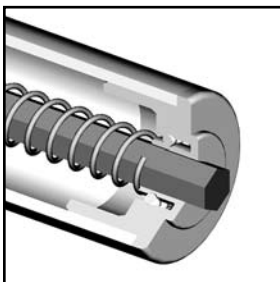

Bearing Type:	Ball
Bore Type:	Through
Roller Material:	PVC

Free turning conveyor roller that is ideal for gravity systems and the precision bearing is also designed for continuous use in driven systems, even at high speeds. Noise levels are significantly reduced and surface build up is minimized. Standard shafts extend 13/16" at each end of a roller. Custom extended shaft lengths are available.

Roller material: beige, rigid PVC.

Bearing is HPR-220 series precision ball bearing mounted in reinforced polypropylene.

Shaft Material	Distance
Part No.	Between
Description	Frames
CS	
304SS	
316SS	



Conveyor Rollers



## Machined Roller End Bearings

 In Stock items (subject to prior sales)

### Roller End Bearings

We constantly manufacture nonstandard rollers to solve design problems and offer maintenance free service in a specific environment. Each of these products makes use of our high performance bearing materials.

#### How To Order Conveyor Roller End Bearings:

The standard part numbers in our tables comprise a full line of roller end bearings manufactured from white UHMW (part numbers starting with "H"). If a custom size is required, provide us with your tubing outside diameter, the gauge thickness and shaft diameter. If an alternative material is required, revise the part number prefix as follows:

**Nolu-S**, use the letter "S" in place of "H"

Nolu-S is a proprietary alloy of food grade lubricants combined with UHMW. This creates a material which retains most of the properties of UHMW while significantly reducing friction. Nolu-S advantages include protection of expensive mating surfaces, lower noise levels and FDA and USDA approved ingredients.

**Arguto-K**, use the letter "A" in place of "H"

**Example:** **HR-190** uses UHMW, **SR-190** uses Nolu-S, **AR-190** uses Arguto-K wood,

A bearing will be supplied with a bore designed for a 1/2" diameter shaft unless a suffix letter is added to the part number from the list below.

#### \*Additional Bores

A=3/16" No Letter= 1/2" M=13/16"

B= 1/4" H= 9/16" N=7/8"

C= 5/16" J= 5/8" Q= 15/16"

E=3/8" K= 11/16" T=1"

F= 7/16" L= 3/4" U= 1-1/16"

Example: **SR-190J**

When Arguto-K bearings will be exposed to wet or moist environments add a further suffix "W" to the part number. Example: AR-200JW

# HT

### Light Duty Bearings

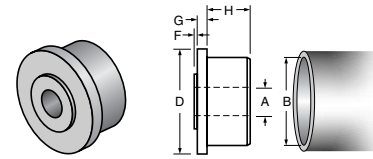

Part Number	A Bore	D Tube OD	Gauge Tube	Tube Wall	B Tube ID	F	G	H
HT-072A	3/16	1/2	20	.035	.430	1/16	1/8	5/16
HT-073A	3/16	1/2	18	.049	.402	1/16	1/8	5/16
HT-082A	3/16	5/8	20	.035	.555	1/16	1/8	5/16
HT-090A	3/16	.706	1/2 EMT	.042	.622	1/16	1/8	1/2
HT-102B	1/4	3/4	20	.035	.680	1/16	1/8	1/2
HT-103B	1/4	3/4	18	.049	.652	1/16	1/8	1/2
HT-104B	1/4	3/4	16	.065	.620	1/16	1/8	1/2
HT-112B	1/4	7/8	20	.035	.805	1/16	1/8	1/2
HT-113B	1/4	7/8	18	.049	.777	1/16	1/8	1/2
HT-114B	1/4	7/8	16	.065	.745	1/16	1/8	1/2
HT-120B	1/4	.922	3/4 EMT	.049	.824	1/16	1/8	1/2
HT-122E	3/8	1	20	.035	.930	1/16	1/8	1/2
HT-123E	3/8	1	18	.049	.902	1/16	1/8	1/2
HT-127E	3/8	1	17	.058	.884	1/16	1/8	1/2
HT-124E	3/8	1	16	.065	.870	1/16	1/8	1/2
HT-130E	3/8	1.050	3/4 Pipe	.113	.824	1/16	1/8	1/2
HT-137E	3/8	1-1/8	17	.058	1.009	1/16	1/8	1/2
HT-134E	3/8	1-1/8	16	.065	.995	1/16	1/8	1/2
HT-140E	3/8	1.163	1 EMT	.057	1.049	1/16	1/8	1/2
HT-142	1/2	1-1/4	20	.035	1.180	1/16	1/8	9/16
HT-143	1/2	1-1/4	18	.049	1.152	1/16	1/8	1/2
HT-144	1/2	1-1/4	16	.065	1.120	1/16	1/8	1/2
HT-150	1/2	1.315	1 Pipe	.133	1.049	1/16	1/8	9/16



HT Series, light duty



HR Series, thru hole



HP/HL Series, blind hole

# CRP

### Stainless Steel Roller Stub Shafts

Available for use in blind hole bearings. Our standard parts are 1/2 inch dia. and are available in two lengths, 3/4 inch and 1-1/2 inch. A 7/16 inch hex section is provided on the outside portion so that an open end wrench may be used to tighten the pin against the conveyor frame using a 5/16 inch UNC bolt.

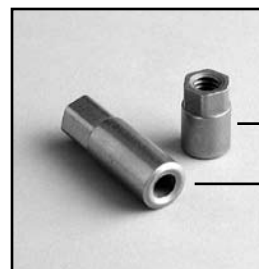
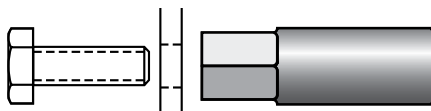

CRP-0812SS  
(HP version)

CRP-0824SS  
(HL version)

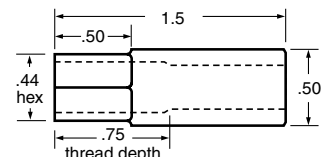
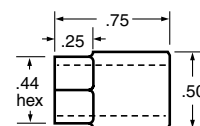

# Machined Roller End Bearings



**In Stock items (subject to prior sales)**

## HR

### Standard Duty Bearings

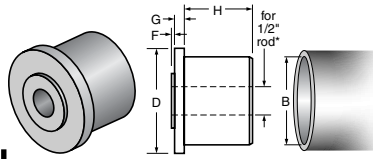

## HP

### Blind Hole Bearings

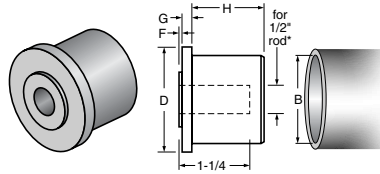

## HL

### Blind Hole Bearings, Long

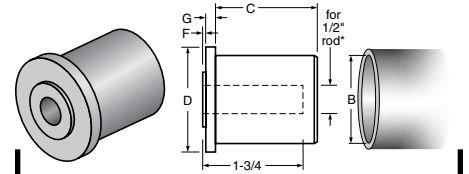

Part Number	Part Number	H
HR-163		1
HR-164		1
HR-173		1-1/4
HR-174	HP-174	1-1/4
HR-175	HP-175	1-1/4
HR-180		1-1/4
HR-184		1-1/4
HR-190		1-1/4
HR-200		1-1/4
HR-204	HP-204	1-1/4
HR-205	HP-205	1-1/4
HR-208		1-1/4
HR-214		1-1/4
HR-216		1-1/4
HR-220	HP-220	1-1/4
HR-224		1-1/4
HR-233		1-1/4
HR-234	HP-234	1-1/4
HR-235	HP-235	1-1/4
HR-236		1-1/4
HR-238		1-1/4
HR-240		1-1/4
HR-250		1-1/4
HR-253		1-1/4
HR-254	HP-254	1-1/4
HR-255	HP-255	1-1/4
HR-256		1-1/4
HR-258		1-1/4
HR-259		1-1/4
HR-264		1-1/4
HR-266		1-1/4
HR-268		1-1/4
HR-270	HP-270	1-1/4
HR-280		1-1/4
HR-284	HP-284	1-1/4
HR-285	HP-285	1-1/4
HR-286		1-1/4
HR-288		1-1/4
HR-289		1-1/4
HR-304		1-1/4
HR-306		1-1/4
HR-308		1-1/4
HR-320		1-1/4
HR-334	HP-334	1-3/8
HR-335	HP-335	1-3/8
HR-336		1-3/8
HR-338		1-3/8

Tube OD D	Tube Gauge	Tube Wall	Tube ID B	F	G
1-3/8	18	.049	1.277	1/16	3/16
1-3/8	16	.065	1.245	1/16	3/16
1-1/2	18	.049	1.402	1/16	3/16
1-1/2	16	.065	1.370	1/16	3/16
1-1/2	14	.083	1.334	1/16	3/16
1.510	1-1/4 EMT	.065	1.380	1/16	3/16
1-5/8	16	.065	1.495	1/16	3/16
1.660	1-1/4 Pipe	.140	1.380	1/16	3/16
1.740	1-1/2 EMT	.065	1.610	1/16	3/16
1-3/4	16	.065	1.620	1/16	3/16
1-3/4	14	.083	1.584	1/16	3/16
1-3/4	11	.120	1.510	1/16	3/16
1-7/8	16	.065	1.745	1/16	3/16
1-7/8	13	.095	1.685	1/16	3/16
1.900	1-1/2 Pipe	.145	1.610	1/16	3/16
1.900	16	.065	1.770	1/16	3/16
2	18	.049	1.902	1/8	1/4
2	16	.065	1.870	1/8	1/4
2	14	.083	1.834	1/8	1/4
2	13	.095	1.810	1/8	1/4
2	11	.120	1.760	1/8	1/4
2.197	2 EMT	.065	2.067	1/8	1/4
2-1/4	2-1/4 Nolu	.154	1.942	1/8	1/4
2-1/4	18	.049	2.152	1/8	1/4
2-1/4	16	.065	2.120	1/8	1/4
2-1/4	14	.083	2.084	1/8	1/4
2-1/4	13	.095	2.060	1/8	1/4
2-1/4	11	.120	2.010	1/8	1/4
2-1/4	10	.134	1.982	1/8	1/4
2-3/8	16	.065	2.245	1/8	1/4
2-3/8	13	.095	2.185	1/8	1/4
2-3/8	11	.120	2.135	1/8	1/4
2.375	2 Pipe	.154	2.067	1/8	1/4
2-1/2	2-1/2 Nolu	.154	2.192	1/8	1/4
2-1/2	18	.049	2.402	1/8	1/4
2-1/2	16	.065	2.370	1/8	1/4
2-1/2	14	.083	2.334	1/8	1/4
2-1/2	13	.095	2.310	1/8	1/4
2-1/2	11	.120	2.260	1/8	1/4
2-1/2	10	.134	2.232	1/8	1/4
2-3/4	16	.065	2.620	1/8	1/4
2-3/4	13	.095	2.560	1/8	1/4
2-3/4	11	.120	2.510	1/8	1/4
2.875	2-1/2 Pipe	.203	2.469	1/8	1/4
3	18	.049	2.902	1/8	1/4
3	16	.065	2.870	1/8	1/4
3	14	.083	2.834	1/8	1/4
3	13	.095	2.810	1/8	1/4
3	11	.120	2.760	1/8	1/4

Part Number	C
HL-174	1-7/8
HL-175	1-7/8
HL-204	1-7/8
HL-220	1-7/8
HL-233	1-3/4
HL-234	1-3/4
HL-235	1-3/4
HL-253	1-3/4
HL-254	1-3/4
HL-255	1-3/4
HL-264	1-3/4
HL-270	
HL-283	1-3/4
HL-284	1-3/4
HL-285	1-3/4
HL-288	1-3/4
HL-304	1-3/4
HL-333	1-3/4
HL-334	1-3/4
HL-335	1-3/4

Conveyor Rollers





## Molded Roller End Bearings

 In Stock items (subject to prior sales)

**Ideal for dry conditions and lighter loads!**

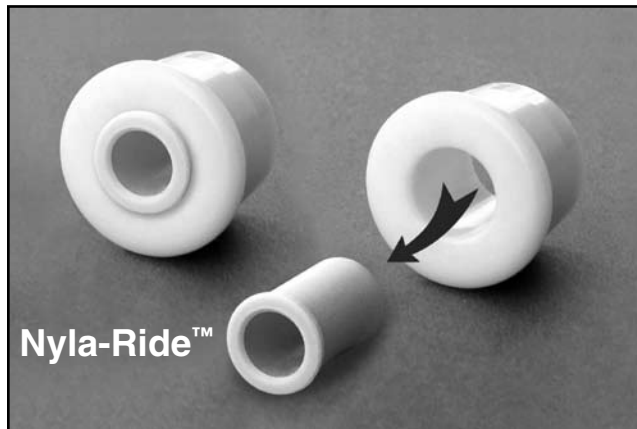

**Nyla-Ride™**

Nyla-Ride™ is a new lubricated nylon material that combines the strength properties of nylon with a lower coefficient of friction.

### Thru Bore

Part Number	Roller OD	A Tube ID	B Bore Dia.	C	Tube Name
<b>NT4-R220</b>	1.9	1.61	1/2	.19	1-1/2" sch. 40 pipe
<b>NT4.5-R220</b>	1.9	1.61	9/16	.19	1-1/2" sch. 40 pipe
<b>NT5-R220</b>	1.9	1.61	5/8	.19	1-1/2" sch. 40 pipe
<b>NT4-R221</b>	1.9	1.5	1/2	.16	1-1/2" sch. 80 pipe
<b>NT4.5-R221</b>	1.9	1.5	9/16	.16	1-1/2" sch. 80 pipe
<b>NT5-R221</b>	1.9	1.5	5/8	.16	1-1/2" sch. 80 pipe
<b>NT4-R250</b>	2-1/4	1.94	1/2	.19	2-1/4" exact pipe
<b>NT4.5-R250</b>	2-1/4	1.94	9/16	.19	2-1/4" exact pipe
<b>NT5-R250</b>	2-1/4	1.94	5/8	.19	2-1/4" exact pipe
<b>NT4-R270</b>	2-3/8	2.07	1/2	.19	2" sch. 40 pipe
<b>NT4.5-R270</b>	2-3/8	2.07	9/16	.19	2" sch. 40 pipe
<b>NT5-R270</b>	2-3/8	2.07	5/8	.19	2" sch. 40 pipe
<b>NT4-R271</b>	2-3/8	1.94	1/2	.16	2" sch. 80 pipe
<b>NT4.5-R271</b>	2-3/8	1.94	9/16	.16	2" sch. 80 pipe
<b>NT5-R271</b>	2-3/8	1.94	5/8	.16	2" sch. 80 pipe
<b>NT4-R280</b>	2-1/2	2.20	1/2	.19	2-1/4" sch. 40 pipe
<b>NT4.5-R280</b>	2-1/2	2.20	9/16	.19	2-1/4" sch. 40 pipe
<b>NT5-R280</b>	2-1/2	2.20	5/8	.19	2-1/4" sch. 40 pipe
<b>NT4-R320</b>	2-7/8	2.47	1/2	.19	2-1/2" sch. 40 pipe
<b>NT4.5-R320</b>	2-7/8	2.47	9/16	.19	2-1/2" sch. 40 pipe
<b>NT5-R320</b>	2-7/8	2.47	5/8	.19	2-1/2" sch. 40 pipe

## NT, NB

### ABS End Cap with Nyla-Ride™ Bearing Insert

Used to fill the ends of the larger PVC tube sizes so that a small inexpensive flanged bearing can be used. Parts are available for five standard PVC conveyor roller sizes from 1.90" to 2-7/8" dia.

**Replace the insert and reuse the roller!**

1/2"  
.50

1/4"  
pipe  
.54

5/8  
.625

Shaft sizes available

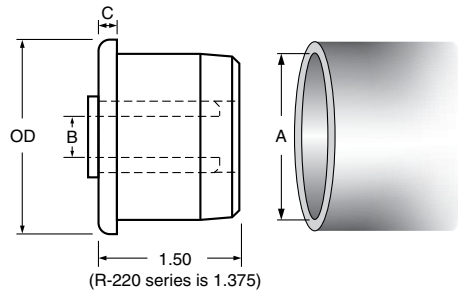

### Blind Bore

Part Number	Roller OD	A Tube ID	B Bore Dia.	C	Tube Name
<b>NB4-R220</b>	1.9	1.61	1/2	.19	1-1/2" sch. 40 pipe
<b>NB4.5-R220</b>	1.9	1.61	9/16	.19	1-1/2" sch. 40 pipe
<b>NB5-R220</b>	1.9	1.61	5/8	.19	1-1/2" sch. 40 pipe
<b>NB4-R221</b>	1.9	1.5	1/2	.16	1-1/2" sch. 80 pipe
<b>NB4.5-R221</b>	1.9	1.5	9/16	.16	1-1/2" sch. 80 pipe
<b>NB5-R221</b>	1.9	1.5	5/8	.16	1-1/2" sch. 80 pipe
<b>NB4-R250</b>	2-1/4	1.94	1/2	.19	2-1/4" exact pipe
<b>NB4.5-R250</b>	2-1/4	1.94	9/16	.19	2-1/4" exact pipe
<b>NB5-R250</b>	2-1/4	1.94	5/8	.19	2-1/4" exact pipe
<b>NB4-R270</b>	2-3/8	2.07	1/2	.19	2" sch. 40 pipe
<b>NB4.5-R270</b>	2-3/8	2.07	9/16	.19	2" sch. 40 pipe
<b>NB5-R270</b>	2-3/8	2.07	5/8	.19	2" sch. 40 pipe
<b>NB4-R271</b>	2-3/8	1.94	1/2	.16	2" sch. 80 pipe
<b>NB4.5-R271</b>	2-3/8	1.94	9/16	.16	2" sch. 80 pipe
<b>NB5-R271</b>	2-3/8	1.94	5/8	.16	2" sch. 80 pipe
<b>NB4-R280</b>	2-1/2	2.20	1/2	.19	2-1/4" sch. 40 pipe
<b>NB4.5-R280</b>	2-1/2	2.20	9/16	.19	2-1/4" sch. 40 pipe
<b>NB5-R280</b>	2-1/2	2.20	5/8	.19	2-1/4" sch. 40 pipe
<b>NB4-R320</b>	2-7/8	2.47	1/2	.19	2-1/2" sch. 40 pipe
<b>NB4.5-R320</b>	2-7/8	2.47	9/16	.19	2-1/2" sch. 40 pipe
<b>NB5-R320</b>	2-7/8	2.47	5/8	.19	2-1/2" sch. 40 pipe

**Color Coded inserts for easy bore size identification!**

**Nyla-Ride™  
Bearing Insert**  
Through bore. Used with ABS end cap.

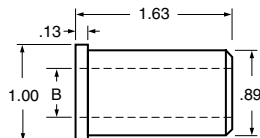

Part Number	Color	B (Bore Dia.)
<b>NT-4</b>	Orange	1/2
<b>NT-4.5</b>	Green	9/16
<b>NT-5</b>	Blue	5/8

**Nyla-Ride™  
Bearing Insert**  
Blind bore. Used with ABS end cap.

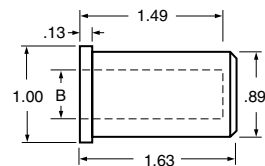

Part Number	Color	B (Bore Dia.)
<b>NB-4</b>	Orange	1/2
<b>NB-4.5</b>	Green	9/16
<b>NB-5</b>	Blue	5/8

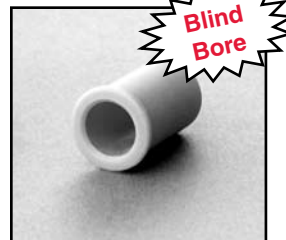

**Solus**



# Molded Roller End Bearings



**In Stock items (subject to prior sales)**

**Premium low friction bearing material!**

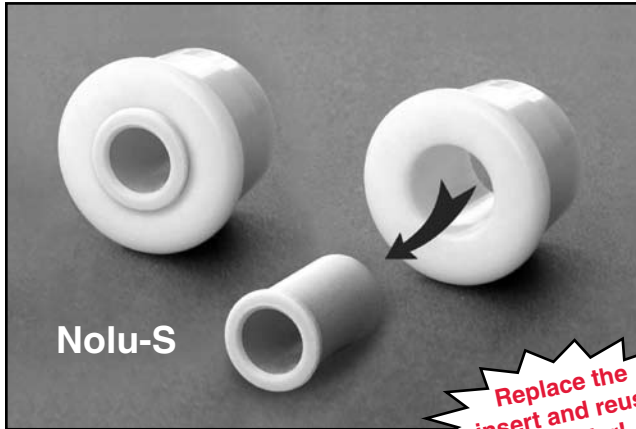

**Nolu-S**

**Replace the insert and reuse the roller!**

## Thru Bore

Part Number	Roller OD	A Tube ID	B Bore Dia.	C	Tube Name
<b>ST4-R220</b>	1.9	1.61	1/2	.19	1-1/2" sch. 40 pipe
<b>ST4.5-R220</b>	1.9	1.61	9/16	.19	1-1/2" sch. 40 pipe
<b>ST5-R220</b>	1.9	1.61	5/8	.19	1-1/2" sch. 40 pipe
<b>ST4-R221</b>	1.9	1.5	1/2	.16	1-1/2" sch. 80 pipe
<b>ST4.5-R221</b>	1.9	1.5	9/16	.16	1-1/2" sch. 80 pipe
<b>ST5-R221</b>	1.9	1.5	5/8	.16	1-1/2" sch. 80 pipe
<b>ST4-R250</b>	2-1/4	1.94	1/2	.19	2-1/4" exact pipe
<b>ST4.5-R250</b>	2-1/4	1.94	9/16	.19	2-1/4" exact pipe
<b>ST5-R250</b>	2-1/4	1.94	5/8	.19	2-1/4" exact pipe
<b>ST4-R270</b>	2-3/8	2.07	1/2	.19	2" sch. 40 pipe
<b>ST4.5-R270</b>	2-3/8	2.07	9/16	.19	2" sch. 40 pipe
<b>ST5-R270</b>	2-3/8	2.07	5/8	.19	2" sch. 40 pipe
<b>ST4-R271</b>	2-3/8	1.94	1/2	.16	2" sch. 80 pipe
<b>ST4.5-R271</b>	2-3/8	1.94	9/16	.16	2" sch. 80 pipe
<b>ST5-R271</b>	2-3/8	1.94	5/8	.16	2" sch. 80 pipe
<b>ST4-R280</b>	2-1/2	2.20	1/2	.19	2-1/4" sch. 40 pipe
<b>ST4.5-R280</b>	2-1/2	2.20	9/16	.19	2-1/4" sch. 40 pipe
<b>ST5-R280</b>	2-1/2	2.20	5/8	.19	2-1/4" sch. 40 pipe
<b>ST4-R320</b>	2-7/8	2.47	1/2	.19	2-1/2" sch. 40 pipe
<b>ST4.5-R320</b>	2-7/8	2.47	9/16	.19	2-1/2" sch. 40 pipe
<b>ST5-R320</b>	2-7/8	2.47	5/8	.19	2-1/2" sch. 40 pipe

## ST, SB

### ABS End Cap with Nolu-S Bearing Insert

Used to fill the ends of the larger PVC tube sizes so that a small inexpensive flanged bearing can be used. Parts are available for five standard PVC conveyor roller sizes from 1.90" to 2-7/8" dia.

**Friction Reducing Nolu-S!!**

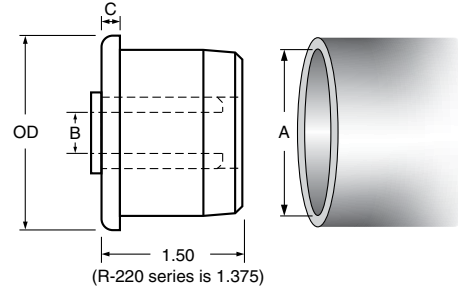

1/2"  
.50

1/4"  
pipe  
.54

5/8  
.625

Shaft sizes available

## Blind Bore

Part Number	Roller OD	A Tube ID	B Bore Dia.	C	Tube Name
<b>SB4-R220</b>	1.9	1.61	1/2	.19	1-1/2" sch. 40 pipe
<b>SB4.5-R220</b>	1.9	1.61	9/16	.19	1-1/2" sch. 40 pipe
<b>SB5-R220</b>	1.9	1.61	5/8	.19	1-1/2" sch. 40 pipe
<b>SB4-R221</b>	1.9	1.5	1/2	.16	1-1/2" sch. 80 pipe
<b>SB4.5-R221</b>	1.9	1.5	9/16	.16	1-1/2" sch. 80 pipe
<b>SB5-R221</b>	1.9	1.5	5/8	.16	1-1/2" sch. 80 pipe
<b>SB4-R250</b>	2-1/4	1.94	1/2	.19	2-1/4" exact pipe
<b>SB4.5-R250</b>	2-1/4	1.94	9/16	.19	2-1/4" exact pipe
<b>SB5-R250</b>	2-1/4	1.94	5/8	.19	2-1/4" exact pipe
<b>SB4-R270</b>	2-3/8	2.07	1/2	.19	2" sch. 40 pipe
<b>SB4.5-R270</b>	2-3/8	2.07	9/16	.19	2" sch. 40 pipe
<b>SB5-R270</b>	2-3/8	2.07	5/8	.19	2" sch. 40 pipe
<b>SB4-R271</b>	2-3/8	1.94	1/2	.16	2" sch. 80 pipe
<b>SB4.5-R271</b>	2-3/8	1.94	9/16	.16	2" sch. 80 pipe
<b>SB5-R271</b>	2-3/8	1.94	5/8	.16	2" sch. 80 pipe
<b>SB4-R280</b>	2-1/2	2.20	1/2	.19	2-1/4" sch. 40 pipe
<b>SB4.5-R280</b>	2-1/2	2.20	9/16	.19	2-1/4" sch. 40 pipe
<b>SB5-R280</b>	2-1/2	2.20	5/8	.19	2-1/4" sch. 40 pipe
<b>SB4-R320</b>	2-7/8	2.47	1/2	.19	2-1/2" sch. 40 pipe
<b>SB4.5-R320</b>	2-7/8	2.47	9/16	.19	2-1/2" sch. 40 pipe
<b>SB5-R320</b>	2-7/8	2.47	5/8	.19	2-1/2" sch. 40 pipe

## Nolu-S Bearing Insert

Through bore. Used with ABS end cap.

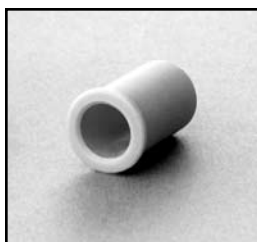
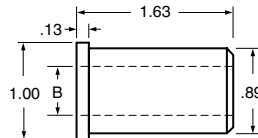

Part Number	B (Bore Dia.)
<b>ST-4</b>	1/2
<b>ST-4.5</b>	9/16
<b>ST-5</b>	5/8

## Nolu-S Bearing Insert

Blind bore. Used with ABS end cap.

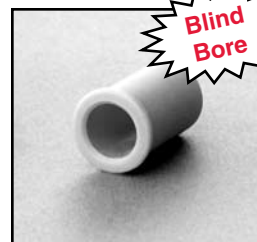
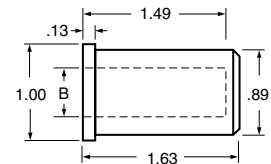

Part Number	B (Bore Dia.)
<b>SB-4</b>	1/2
<b>SB-4.5</b>	9/16
<b>SB-5</b>	5/8

Conveyor Rollers

**Solus**



## Roller Components

 In Stock items (subject to prior sales)

### CR4

#### Round Roller Shafts

Female threads on both ends.

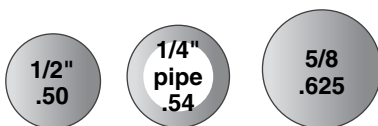
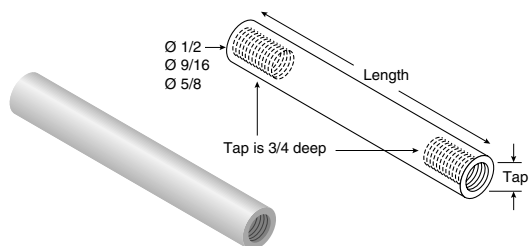

Shaft sizes available

**Material:** 303 stainless steel.

Ø 1/2" Part Number	Length	Tap
VF-CR4-SS-0325-516	3.50	5/16-18
VF-CR4-SS-0325-38	3.50	3/8-16
VF-CR4-SS-0400-516	4.25	5/16-18
VF-CR4-SS-0400-38	4.25	3/8-16
VF-CR4-SS-0450-516	4.75	5/16-18
VF-CR4-SS-0450-38	4.75	3/8-16
VF-CR4-SS-0600-516	6.25	5/16-18
VF-CR4-SS-0600-38	6.25	3/8-16
VF-CR4-SS-0750-516	7.75	5/16-18
VF-CR4-SS-0750-38	7.75	3/8-16

Ø 9/16" Part Number	Length	Tap
VF-CR4.5-SS-0325-38	3.50	3/8-16
VF-CR4.5-SS-0400-38	4.25	3/8-16
VF-CR4.5-SS-0450-38	4.75	3/8-16
VF-CR4.5-SS-0600-38	6.25	3/8-16
VF-CR4.5-SS-0750-38	7.75	3/8-16

Ø 5/8" Part Number	Length	Tap
VF-CR5-SS-0325-38	3.50	3/8-16
VF-CR5-SS-0400-38	4.25	3/8-16
VF-CR5-SS-0450-38	4.75	3/8-16
VF-CR5-SS-0600-38	6.25	3/8-16
VF-CR5-SS-0750-38	7.75	3/8-16

### CRP

#### Stainless Steel Roller Stub Shaft

For use in blind hole bearings. Stub shaft is 1/2 inch dia. and an 1-1/2 inch in length. A 7/16 inch hex section is provided on the outside portion so that an open end wrench may be used to tighten the pin against the conveyor frame using a 5/16 inch UNC bolt.



CRP-0824SS

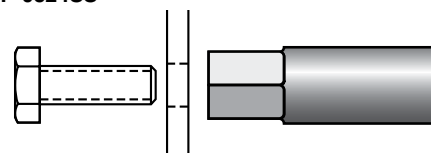
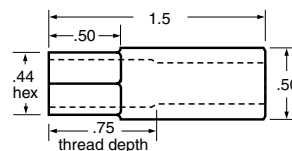

### HXA

#### Steel Hex Shaft Adapters

Used to slip over hex shafting so that the outside diameter of the adapter becomes a journal surface on which the bearing in the roller can rotate. Parts are available in both carbon and 316 stainless steel.

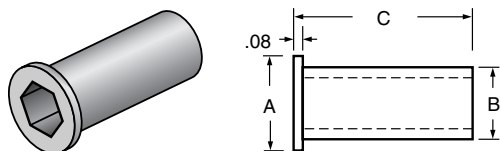

Part Number	Material	Hex Shaft	A Dia.	B Dia.	C Length
HXA-522SS	stainless steel	5/16"	3/4"	0.565	1-3/8"
HXA-722	steel	7/16"	13/16"	0.628	1-3/8"
HXA-732	steel	7/16"	13/16"	0.628	2"
HXA-732SS	stainless steel	7/16"	13/16"	0.628	2"
HXA-1132	steel	11/16"	1-1/8"	0.94	2"
HXA-1132SS	stainless steel	11/16"	1-1/8"	0.94	2"

### FF-166

#### ABS Shaft Caps

Used on the ends of 7/16" hex or round shafts. They provide a simple method of retaining the shaft in the roller assembly. Primarily they are designed to offer a means of mounting the roller in the side frames, in a way that metal to metal contact can be avoided. With an 11/16" wide, open ended slot in the side frame, wear and noise can be eliminated.

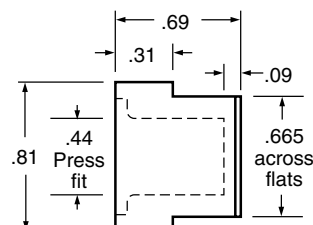
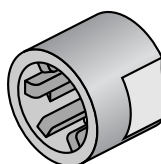



**In Stock items (subject to prior sales)**

## NBB

### Plastic Ball Bearings

Designed for use with Nolu PVC tubing. Standard bearings use high performance Acetal Races and 420 stainless alloy balls. The same bearings are available with Polypropylene races and 316 stainless steel balls for use in highly corrosive environments such as battery manufacturing plants. However, custom made bearings can be designed to meet your needs.

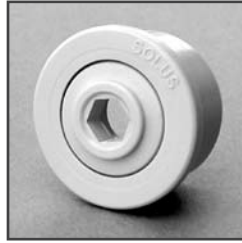

Part Number	Material	B Dia.	C	D Dia.	E	F	A Shaft
<b>NBB-110</b>	Acetal	.63	.125	.81	.06	.625	1/4" dia.
<b>NBB-130</b>	Acetal	.83	.10	1.06	.12	.625	5/16" hex
<b>NBB-145</b>	Acetal	1.03	.125	1.18	.118	.729	5/16" dia.
<b>NBB-150</b>	Acetal	1.06	.125	1.31	.187	.750	5/16" hex
<b>NBB-220</b>	Acetal	1.62	.12	1.90	.185	.935	7/16" hex
<b>SPB-220</b>	Polypropylene	1.62	.12	1.90	.185	.935	7/16" hex

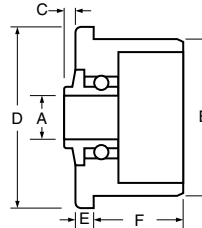

## LSB

### Labyrinth Sealed Ball Bearings

Designed for use with carbon or stainless steel tubing. These bearing assemblies are created using a unique 3 piece housing which makes it extremely difficult for contaminants to reach the core bearing. These roll end bearings can be ordered with a variety of bearing inserts.

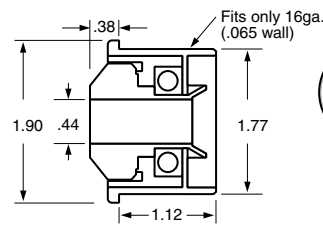
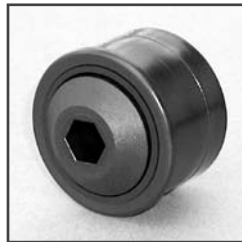

Part Number	Description	Shaft Size
<b>222LSB-224-01</b>	HDPE housing with carbon steel caged bearing insert	7/16
<b>222LSB-224-02</b>	HDPE housing with carbon steel double shielded bearing insert	7/16
<b>222LSB-224-03</b>	HDPE housing with carbon steel double rubber sealed bearing insert	7/16

## SBR

### Stub Shaft Ball Bearings

Designed for use in light duty gravity applications. The stainless steel stub shafts are spring loaded to ease the assembly into a frame which has been threaded to accept the M8 roller shaft threads. Acetal housing.

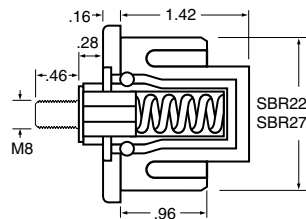

Part Number	OD
<b>SBR-220</b>	1.90"
<b>SBR-270</b>	2.37"

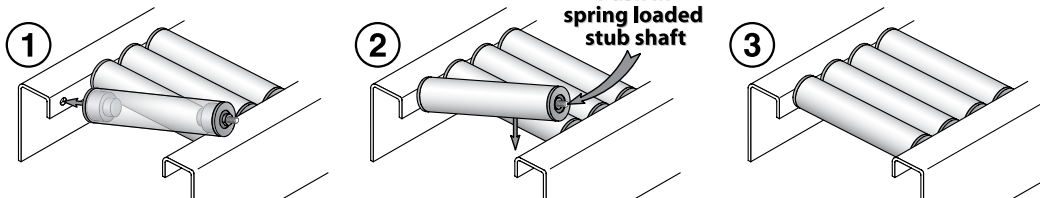

## HPR

### High Performance Ball Bearings

Designed for use with Nolu PVC tubing. These bearings are fitted with a special polypropylene housing assembly incorporating a high performance, shielded 6000 series ball bearing. This bearing is ideal for continuous use in driven systems and the precision bearing can also be used in gravity applications.

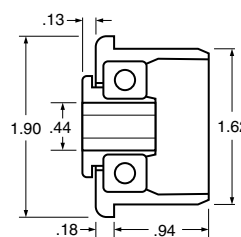

Part Number	Shaft Size
<b>HPR-220</b>	7/16"

Conveyor Rollers



## Roller End Bearings

 In Stock items (subject to prior sales)

### VRE

#### Roller Ends

Easily assembled onto any lengths of pipe. Fast installation. Quiet, sanitary operation. Glue fit assembly into 1-1/2 inch schedule 40 PVC pipe. Thru shaft bore.

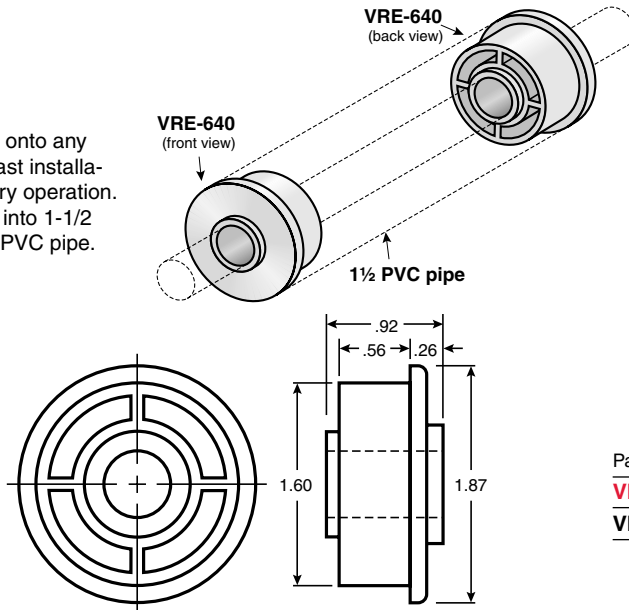

Part Number	Shaft	Tube Name
<b>VRE-640-1540-12</b>	1/2	1-1/2" sch. 40 PVC pipe
<b>VRE-640-1540-58</b>	5/8	1-1/2" sch. 40 PVC pipe

### NRB

#### Acetal End Bearings

Inexpensive, injection molded conveyor roll bearings designed for light duty applications. However, with a 7/16" hex shaft, a low cost, higher performance roller can be produced by combining the Acetal bearing with a Nolu-S Hex Adapter. These Acetal bearings are available with various bore sizes and fit our most popular PVC tubing sizes.

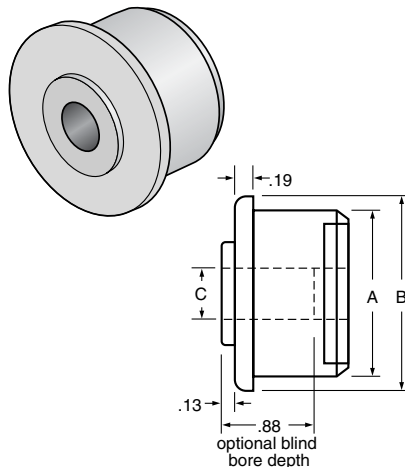

Part Number	C Dia.	A Dia.	B Dia.	Tube Name
<b>NRB-220/5</b>	5/16	1.62	1.90	1-1/2" sch. 40 pipe
<b>NRB-220/8</b>	1/2	1.62	1.90	1-1/2" sch. 40 pipe
<b>NRB-220/8B*</b>	1/2	1.62	1.90	1-1/2" sch. 40 pipe
<b>NRB-220/9</b>	9/16	1.62	1.90	1-1/2" sch. 40 pipe
<b>NRB-220/10</b>	5/8	1.62	1.90	1-1/2" sch. 40 pipe
<b>NRB-270/8</b>	1/2	2.09	2.37	2" sch. 40 pipe
<b>NRB-270/8B*</b>	1/2	2.09	2.37	2" sch. 40 pipe
<b>NRB-270/10</b>	5/8	2.09	2.37	2" sch. 40 pipe

\*Blind bore

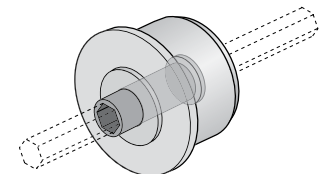

### Nolu-S Rod

#### Nolu-S Rod

Nolu-S material and its outstanding characteristics; low friction, higher speed capability, self lubrication, is available in bulk extruded rod form. These rods are ideal for machining various types of plastic components including roller end bearings.

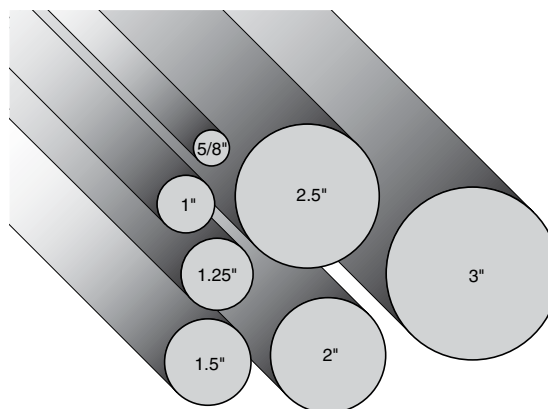

Part Number	Diameter (in.)	Length (ft.)
<b>012R10A-5</b>	5/8	5
<b>012R16A-5</b>	1	5
<b>012R20A-5</b>	1-1/4	5
<b>012R24A-5</b>	1-1/2	5
<b>012R32A-5</b>	2	5
<b>012R40A-5</b>	2-1/2	5
<b>012R48A-5</b>	3	5
<b>012R10A-10</b>	5/8	10
<b>012R16A-10</b>	1	10
<b>012R20A-10</b>	1-1/4	10
<b>012R24A-10</b>	1-1/2	10
<b>012R32A-10</b>	2	10
<b>012R40A-10</b>	2-1/2	10
<b>012R48A-10</b>	3	10



## Sleeve Bearings or Ball Bearings?

Bearing selection is the key to improved conveyor roller performance and the elimination of downtime. Bearing performance depends not only on the use of an engineered bearing material, but also on the material selected for the mating surface.

### Sleeve Bearing Types

#### Nolu-S Plastic Sleeve Bearings

Nolu-S is a proprietary alloy of food grade lubricants combined with UHMW. This creates a material which retains most of the properties of UHMW while significantly reducing friction. Nolu-S advantages include protection of expensive mating surfaces, lower noise and FDA and USDA approved ingredients. These bearings are used in the highest performance units produced by Solus Industrial Innovations.

#### Nyla-Ride™ Bearing Inserts

Nyla-Ride™ is a new lubricated nylon material that combines the strength properties of nylon with a lower coefficient of friction. Color coding easily identifies the bore size.

#### UHMW Plastic Sleeve Bearings

The most abrasion resistant plastic ever developed. At slow speeds these bearings provide wear resistance where there is a high concentration of abrasive particles. However, as the conveyor speed increases, Nolu-S bearings must be used to reduce friction and wear.

#### Arguto-K Impregnated Wood Sleeve Bearings

Made from hardwood maple, impregnated with fluid lubricants. These bearings are the most stable under heavy loads and can be used in high speed conveyors. Like Nolu-S bearings, they generate an oil film on demand through frictional heat. This results in reduced friction and wear. The oil film also protects any metal mating surface from rusting, which can cause additional wear.

#### Nolu Acetal Plastic Bearing

Inexpensive, injection molded conveyor roll bearings designed for light duty applications. However, with a 7/16" hex shaft, a low cost, higher performance roller can be produced by combining the Acetal bearing with a Nolu-S Hex Adapter. These Acetal bearings are available with various bore sizes and fit our most popular PVC tubing sizes.

### Ball Bearing Types

#### Nolu Plastic Ball Bearings

Designed for use with the Nolu PVC tubing. Standard bearings use high performance Acetal Races and 420 stainless alloy balls. The same bearings are available with Polypropylene races and 316 stainless steel balls for use in highly corrosive environments such as battery manufacturing plants. However, custom made bearings can be designed to meet your needs.

#### LSB Ball Bearing

Designed for use with 1.9 diameter, 16 gauge tubing. This revolutionary three piece housing design makes it increasingly difficult for abrasives and contaminants to reach the bearing insert. A variety of 6000 Series inserts can be provided.

#### HPR-220 Nolu High Performance Ball Bearings

A special high performance ball bearing assembly designed to be used in many demanding applications. This bearing assembly consists of a high performance 6000 Series shielded ball bearing encased in a reinforced Polypropylene housing. This configuration provides the lowest coefficient of friction, excellent load capacity, and high speed capabilities. It is available to fit our most popular PVC size and comes standard with a 7/16" hex bore.

### Roller Tubes

#### High Impact PVC Tube

Available in nine standard diameters ranging from 13/16" to 2-7/8" dia. The recommended load capacity at room temperature is shown in chart #1, the service temperature range being between -10°F and +140°F.

#### Steel Reinforcing Tube

Used to increase the stiffness of the above PVC tubing by a factor of 10. This tube is made of carbon steel and therefore must be encapsulated by using blind hole bearings if corrosion is anticipated. The recommended capacity of our standard PVC rollers should never be exceeded (max. 200lbs./roller).

### Roller Components

#### ABS Plastic End Plug

Used to fill the ends of the larger PVC tube sizes so that a small inexpensive flanged bearing can be used. Parts are available for five standard PVC conveyor roller sizes from 1.90" to 2-7/8" dia.

#### Steel Hex Adapters

Used to slip over hex shafting so that the outside diameter of the adapter becomes a journal surface on which the bearing in the roller can rotate. Parts are available for 5/16" hex, 7/16" hex and 11/16" hex assemblies in both carbon and 316 stainless steel.

#### Nolu-S Plastic Hex Adapters

Also used to slip over 7/16" hex shafting. They are primarily designed for use with Nolu Acetal plastic bearings. In use, an oil film is generated at the bearing surface which reduces friction and wear. The service temperature range is normally between -10°F and +140° F. Steel hex adapters should be used where there is a high concentration of abrasive particles.

#### Stainless Steel Roller Stub Shafts

Available for use in blind hole bearings. Our standard parts are Ø1/2" and are available in two lengths, 3/4" and 1-1/2". A 7/16" hex section is provided on the outside portion so that a "C" wrench may be used to tighten the pin against the conveyor frame using a 5/16" UNC bolt.

#### ABS Plastic Shaft Caps

Used on the ends of 7/16" hex or round shafts. They provide a simple method of retaining the shaft in the roller assembly. Primarily they are designed to offer a means of mounting the roller in the side frames in a way that metal to metal contact can be avoided. With an 11/16" wide, open ended slot in the side frame, noise and frame wear can be eliminated.

#### UHMW Sprockets

Available to custom fit our standard rollers to a driven system. These UHMW sprockets are problem solvers in dirty or corrosive environments. They extend the life of the chain and are much quieter.





## Roller Capacity

A roller should be selected which will provide maximum rigidity within normal design limitations. Choose the largest diameter possible and keep the length to a minimum. This will minimize deflection in the roller and transmit more even loading to the bearings. However, many bearing failures can be attributed, in part, to design loads which were based solely on the strength

of the tube stock without regard for bearing capacity. The recommended maximum roller load capacity is the lower of the two readings from Chart #1 and Chart #2. Nolu produces a steel reinforced version of these rollers which will increase the capacity from Chart #1 by a factor of 10. Nolu PVC rollers can be designed to carry up to 200 lbs.

**Chart #1**

This chart shows the load capacity of our High-Impact PVC Tubing

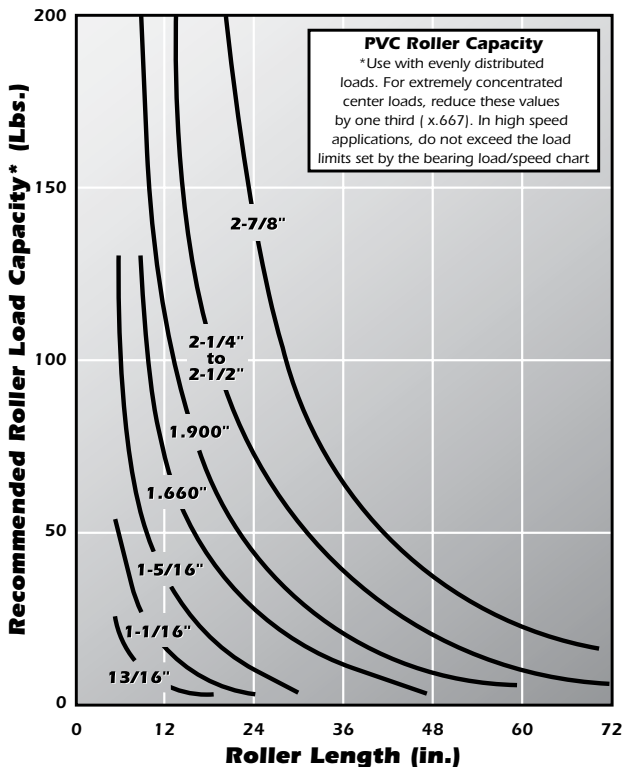

**Chart #2**

This chart identifies the performance limitations of our high performance sleeve bearings

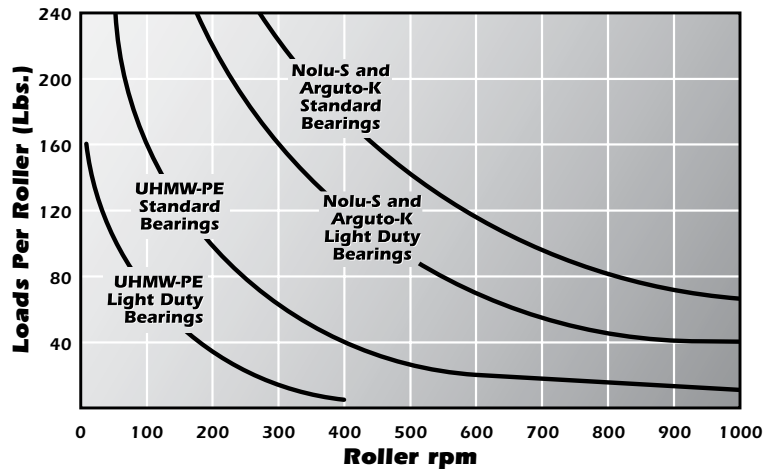

## Bearing Service Life

Surface Speed (feet per minute)	Radial Load (lbs. per roller)			Static Load Capacity
	5	10	15	
30	58,000 hours	29,000 hours	23,000 hours	45 lbs.
60	29,000 hours	14,000 hours	11,000 hours	45 lbs.
100	17,000 hours	8,000 hours	7,000 hours	45 lbs.

**Table #1**

Estimated average bearing life for Nolu plastic ball bearings in a clean environment. Bearing life will be reduced by impact loads and by exposure to contamination. With longer rollers the load capacity may be limited to the rigidity of the PVC tube, see chart #1 above.

